

## COLLET HOLDERS FOR TRAUB AUTOMATS A3 & A4 SHANK

A3 / ER

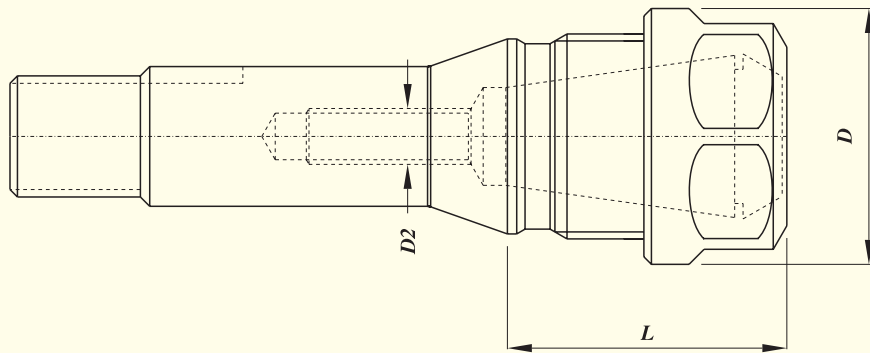

Maximum runout of the internal taper in relation to the external taper 0.005 mm

Collet Chuck Designation	Suitable for Collet	Collet Clamping Capacity	L	D2	Nut		Spanner Designation
					D	Designation	
A3 ER 16030	ER 16	0,5 - 10	30	M 6 x 1	28	UM/ER 16	GS 25
A4 ER 32050	ER 32	2 - 20	50	M 12 x 1	50	UM/ER 32	E 32

Ordering Example :-  
KTA A3 ER 16030/Qty. - 2 Nos.

For Ball Bearing Nut  
refer page no. 23

J / ER DIN

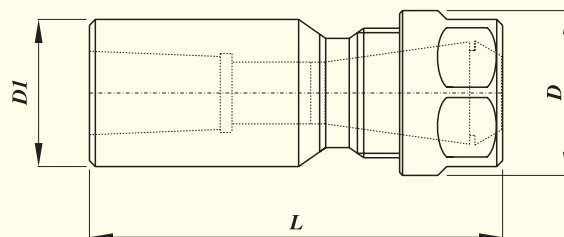

Maximum runout of the internal taper in relation to the internal taper 0.005 mm

Collet Chuck Designation	Suitable for Collet	Collet Clamping Capacity	L	D1	Nut		Spanner Designation
					D	Designation	
J2 ER 16	ER 16	0,5 - 10	70	25	28	UM/ER 16	GS 25
J6 ER 20	ER 20	1 - 13	70	34	34	UM/ER 20	E 20

Ordering Example :-  
KTA J2 ER 16/Qty. - 2 Nos.

For Ball Bearing Nut  
refer page no. 23

B / ER  
DIN 238

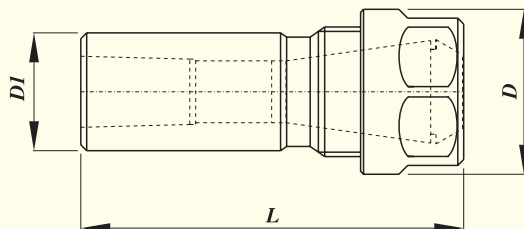

Maximum runout of the internal taper in relation to the internal taper 0.005 mm

Collet Chuck Designation	Suitable for Collet	Collet Clamping Capacity	L	D1	Nut		Spanner Designation
					D	Designation	
B12 ER 16	ER 16	0,5 - 10	65	25	28	UM/ER 16	GS 25
B16 ER 20	ER 20	1 - 13	70	34	34	UM/ER 20	E 20

Ordering Example :-  
KTA B12 ER 16/Qty. - 2Nos.

For Ball Bearing Nut  
refer page no. 23